

# *2021 Virginia Governor's Cup Mine Rescue and Safety Competition*

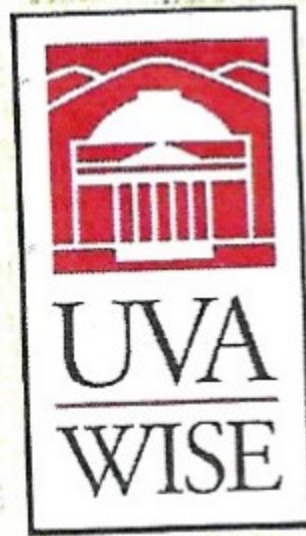

**METALLURGICAL**  
COAL PRODUCERS ASSOCIATION

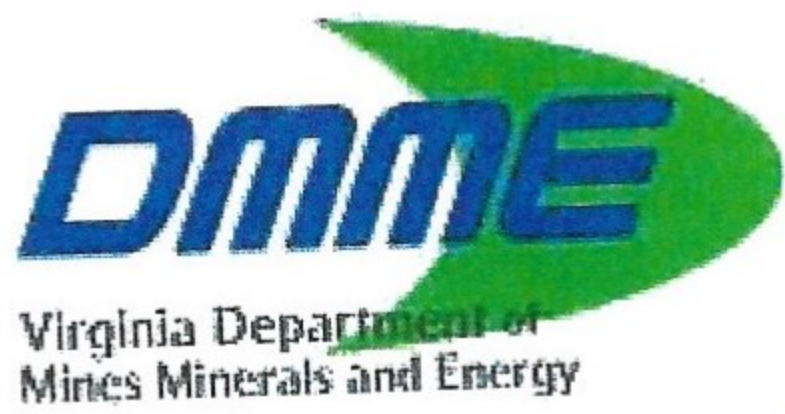

**Wednesday June 9<sup>th</sup>, 2021**

*The University of Virginia's College at Wise  
1 College Avenue • Wise, VA 24293*

## Governor's Cup 2021 Written Statement Instructions

Thank you for responding to our emergency. You are located in the fresh-air-base of the Met-Coal #1 mine. The fresh-air-base was established by a previous team and all areas outby the fresh-air-base are safe to ventilate through.

The mine is ventilated with an exhaust fan and air normally intakes in the No.3 entry and exhausts out the No.1 and No.2 entries. The fan is currently off but can be started by contacting the Command Center. Mining is in the northern direction.

Last night at 12:01 AM, three miners entered the mine to perform maintenance on the working section. At 2:00 AM, one of the miners exited the mine. He stated there had been an ignition and he was unable to locate his buddies. Subsequent attempts to contact the miners have been unsuccessful. The mine has a history of methane, bad roof, and water. The mine maps are up to date. State and Federal agencies have been notified and are present. A backup mine rescue team is also present. Two blank maps and the problem's written instructions will be provided when you are ready to begin working.



## Governor's Cup 2021 Written Problem Instructions

- Explore all areas of the mine that can be safely accessed
- Once started, the mine fan cannot be stopped, reversed, or stalled
- At each apparatus check, the name of the team member with the lowest oxygen level and the oxygen level must be called out to the command center prior to the team moving from that stop.
- A time limit of 90 minutes has been established for this problem. The team will be advised 10 minutes prior to this time limit expiring.



# 1<sup>st</sup> Ventilation

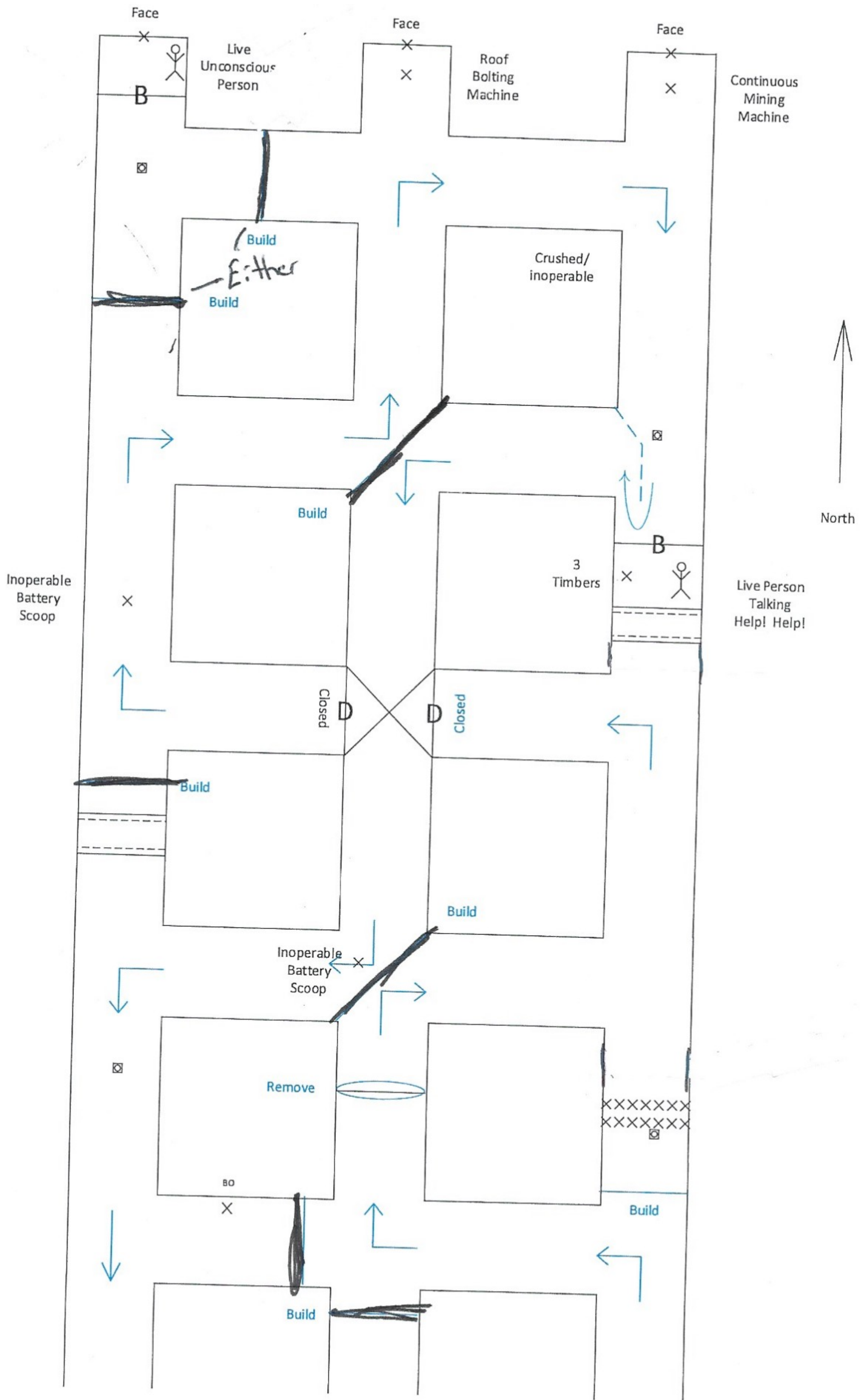

# 2nd Ventilation

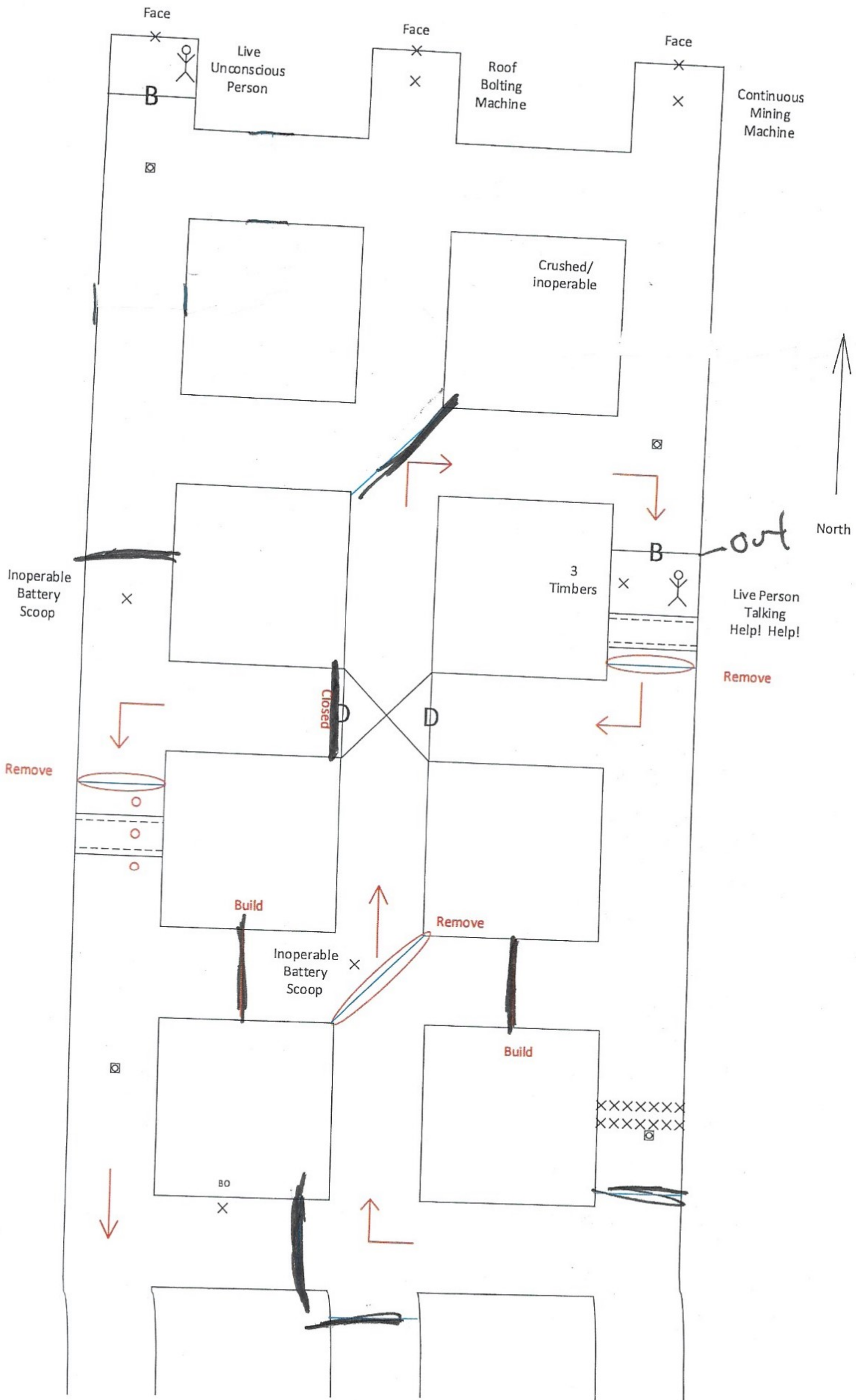

# 3rd Ventilation

